

WELL& by Durst™



WELL& BY DURST @ 825 THIRD Conference & Meeting Spaces

Exclusively designed for Durst tenants, Well& by Durst at 825 Third provides a spectacular setting to unwind, collaborate, and network while enjoying skyline views. It's the perfect destination for any occasion with flexible conferencing and breakout areas, as well as a wraparound terrace, that accommodate events of various sizes and styles.

3

meeting rooms

240

max capacity

9,783

square feet



High-Speed
Wi-Fi



Flexible Meeting &
Event Space



State-of-the-Art
Technology



Complimentary
Drinks & Snacks



Preferred
Caterers



Event Planning
Services

Contact us to assist you in selecting the best meetings or event solution for your company.

WELL& BY DURST @ 825 THIRD

Conference & Meeting Spaces



WELL& BY DURST @ 825 THIRD

Conference Room Floorplans

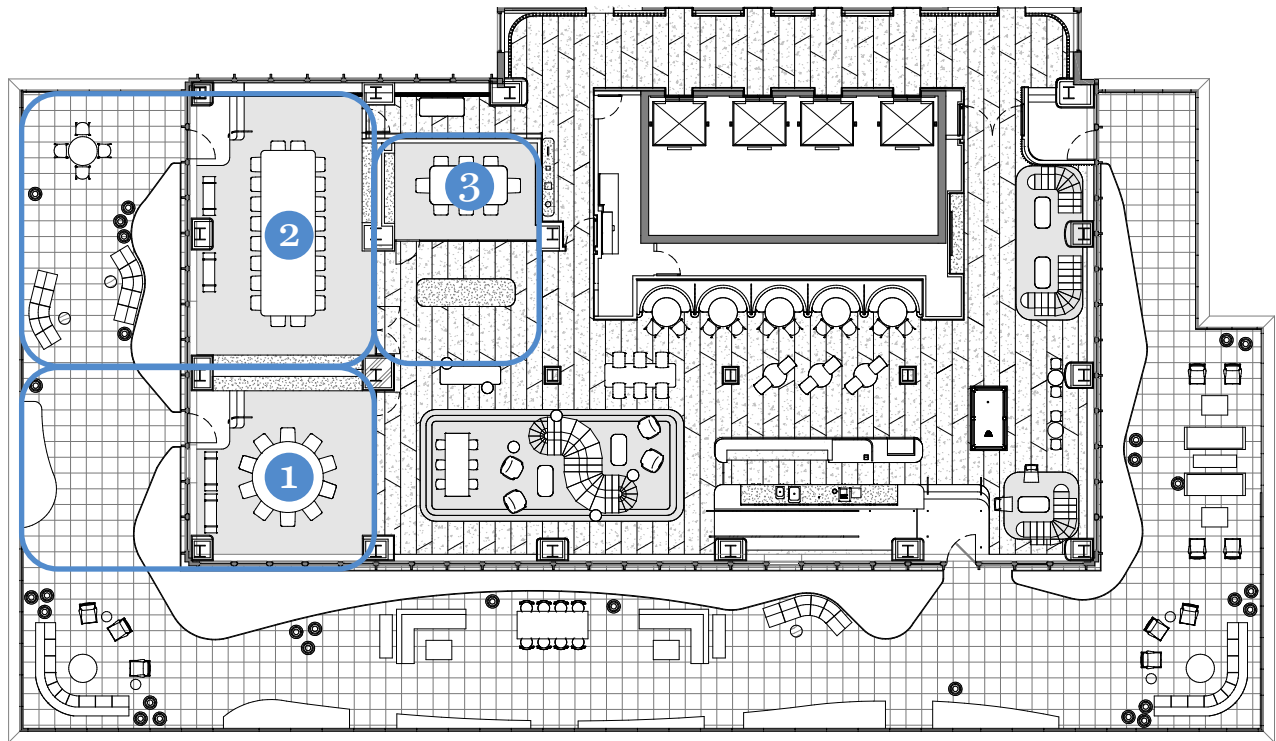

ROOMS & CAPACITIES

ROOMS	SIZE	CAPACITY	HOURLY	HALF DAY (4 hours)	FULL DAY (4+ hours)	AFTER HOURS & WEEKEND (4+ hours)
1 East River	533 SF	10 people	\$250	\$900	\$1,700	\$2,000
2 Sutton Place	1,346 SF	40 people	\$500	\$1,900	\$3,700	\$4,000
3 Greenacre	240 SF	8 people	\$150	\$500	\$900	\$1,200

*All conference rooms have access to the catering counter

WELL& BY DURST @ 825 THIRD

Buyout Floorplans

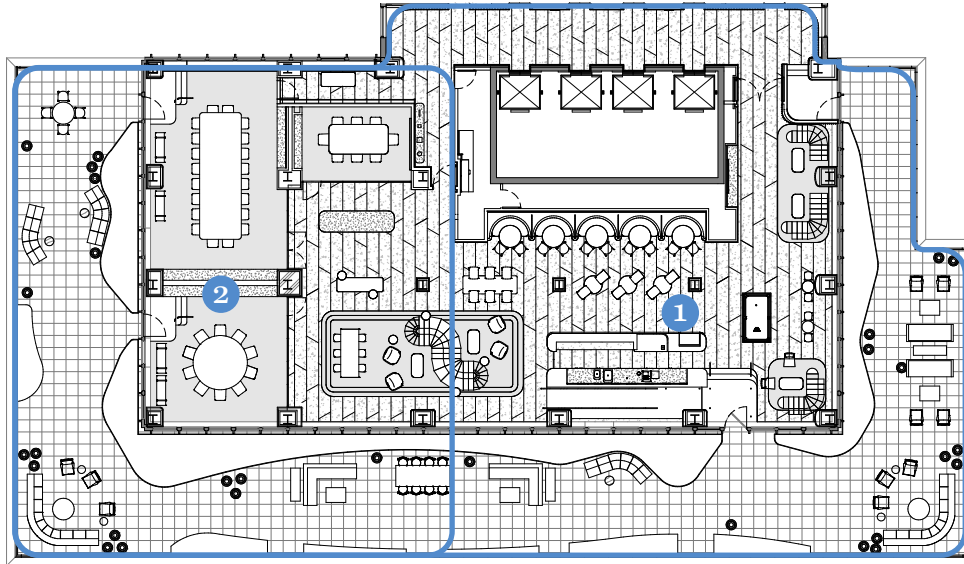

BUYOUTS & CAPACITIES

SPACE	RECEPTION WITH TERRACE	RECEPTION	HALF DAY (4 hours)	FULL DAY (4+ hours)	AFTER HOURS & WEEKEND (4+ hours)
1 Full Buyout	240 people	115 people	\$5,000	\$7,500	\$9,000
2 West Buyout	150 people	85 people	\$3,000	\$5,500	\$7,000

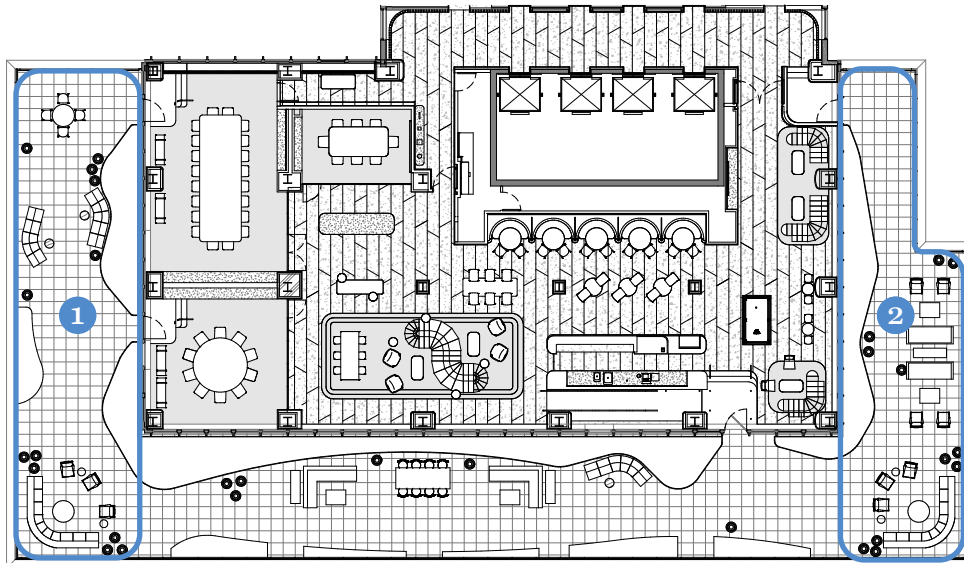

SPACE	RECEPTION	HALF DAY (4 hours)	FULL DAY (4+ hours)	AFTER HOURS & WEEKEND (4+ hours)
1 West Terrace	75 people	\$1,000	\$1,500	\$2,000
2 East Terrace	75 people	\$1,000	\$1,500	\$2,000